



6.2L Front End Accessory Drive (FEAD) Kit

77072492

6.2L Supercharged Crate HEMI

www.mopar.com

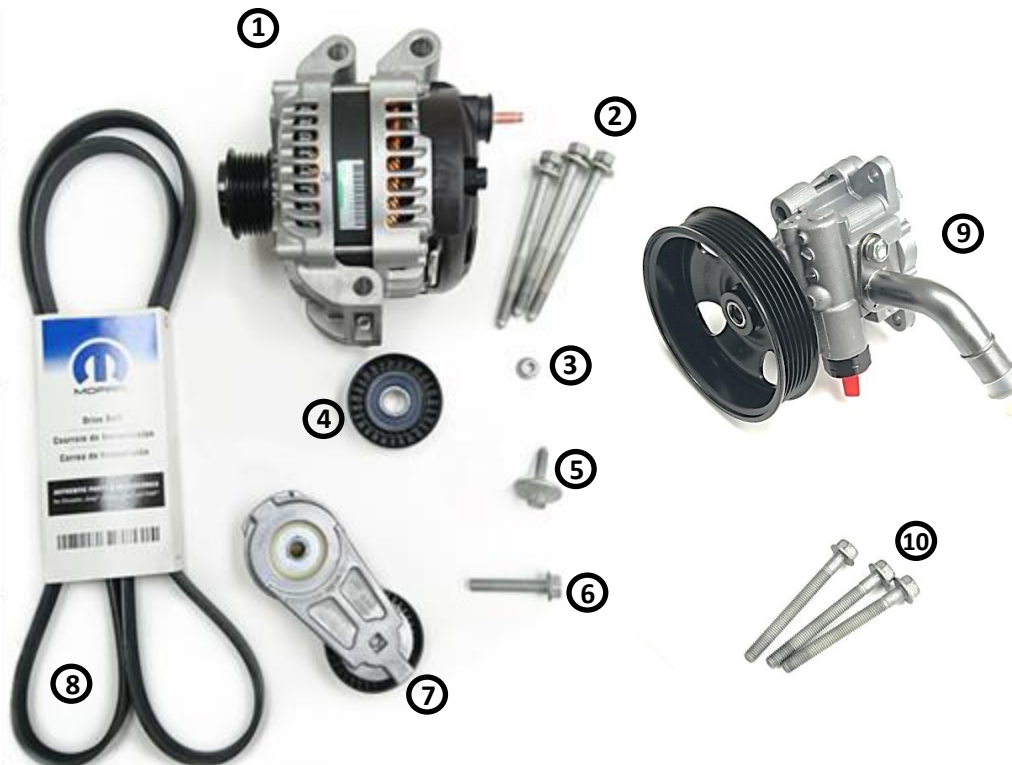

Item	Description	Part Number	Quantity
	6.2L FEAD Kit with Power Steering	77072492	
1	Generator	04801834AB	1
2	Generator Bolt	06506022AA	3
3	Generator Nut	06502720	1
4	Pulley, Idler - Smooth	04891720AA	1
5	Bolt Pulley, M8x1.25x34	06509487AA	1
6	Tensioner Bolt, M10X1.50X55.00	06104221AA	1
7	Tensioner	04861660AA	1
8	Belt - 2011mm	05281261AA	1
9	Power Steering Pump	05181854AA	1
10	Bolts M8x1.25x85.00	06102184AA	3

PLEASE READ ALL INSTRUCTION PRIOR TO INSTALLATION.

CALL MOPAR FOR ASSISTANCE OR FOR FRENCH/SPANISH INSTRUCTIONS 1-888-528-HEMI (4364)

1. Position the generator (2) and install the three generator bolts (1) and tighten the generator retaining bolts to the proper torque specification 54 N·m (40 Ft·Lbs).

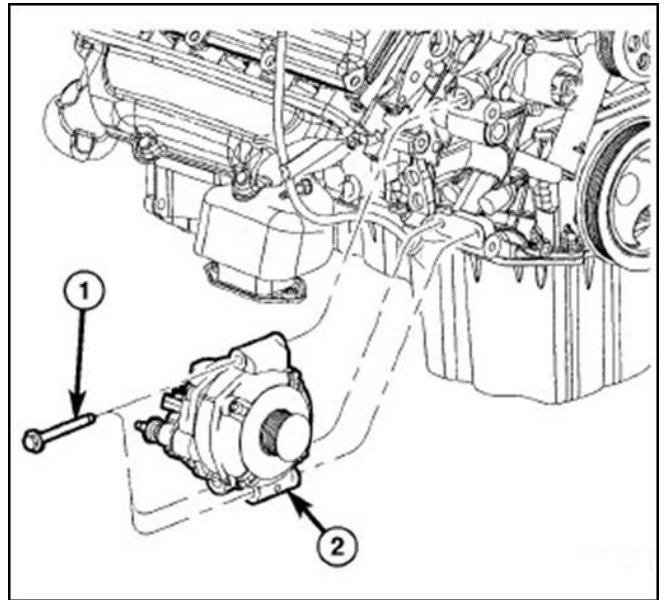

2. Position the generator B+ terminal eyelet to the generator output stud, install the retaining nut (3) and tighten to the proper torque specification 14 N·m (10 Ft·Lbs).

3. Install the insulator cover (2) onto the B+ output terminal.

4. Snap the field wire connector (1) into the rear of the generator.

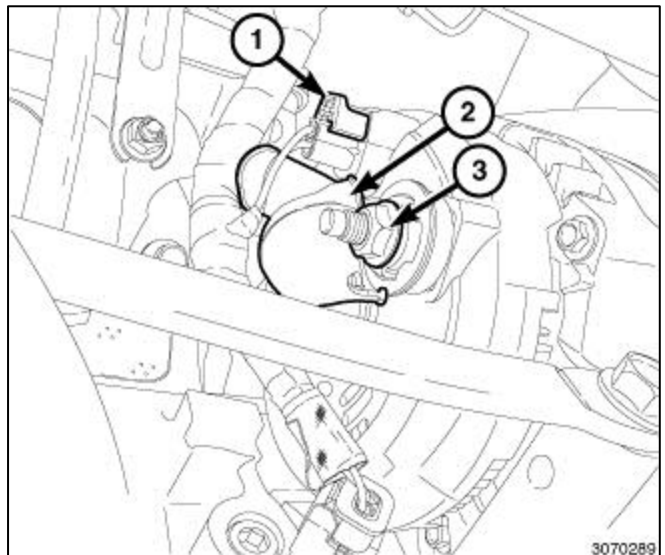

5. Install the smooth idler pulley (1). Tighten the idler pulley bolt (2) to the proper torque specification 29 N·m (21 Ft·Lbs).

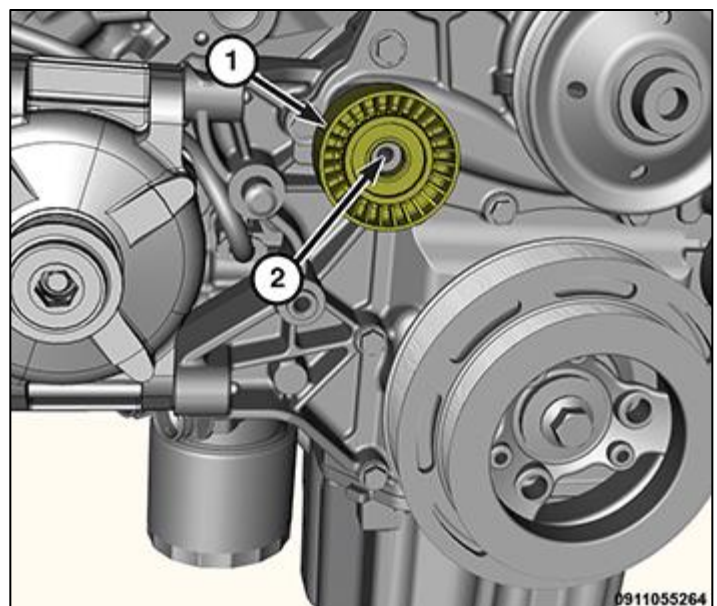

6. Align the locator tang and install the belt tensioner. Tighten the tensioner bolt (3) to the proper torque specification 55 N·m (41 Ft·Lbs).

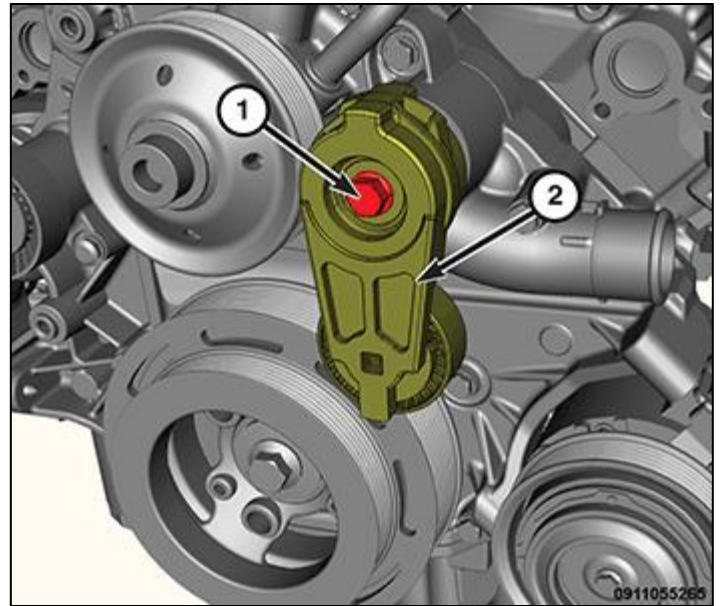

7. Position the power steering pump (1) and using the holes in the pulley for access, install 3 pump mounting bolts (5) and tighten to 28 N·m (21 ft. lbs.).

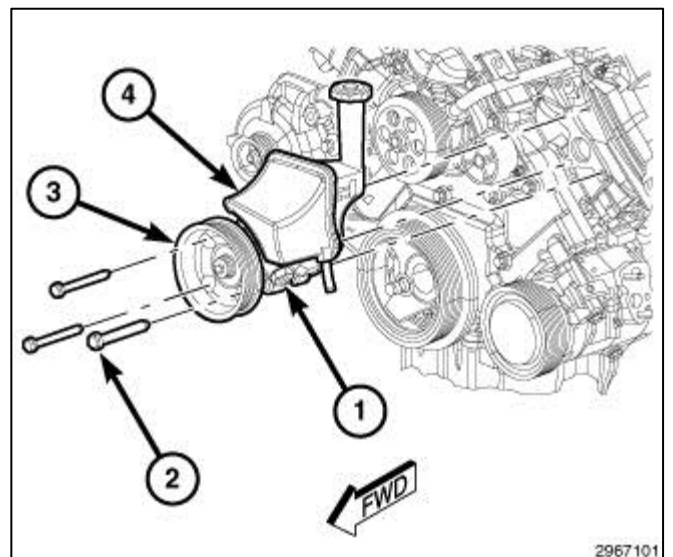

8. Install the pressure line (2) on the pump (3) and tighten the power steering nut to 38 N·m (28 ft. lbs.). Fitting size for pressure line is M16x1.5.

9. Install the supply hose (1) on the pump (3) and securely tighten with a clamp.

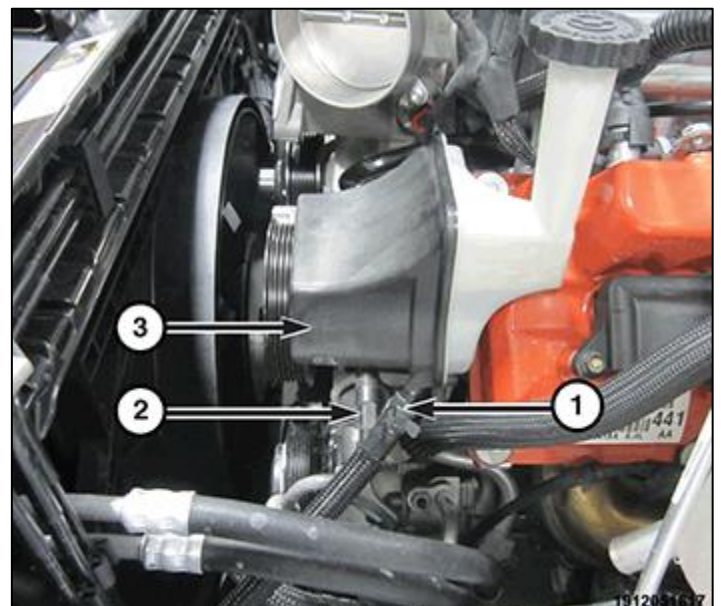

NOTE: When installing accessory drive belt onto pulleys, make sure that belt is properly routed and all V-grooves make proper contact with pulleys.

10. Position the drive belt (2) over all pulleys except for the water pump pulley (7).

11. Rotate the tensioner (8) **clockwise** and slip the belt (2) over the water pump pulley (7).

12. Gently release tensioner (8).

13. Fill and bleed the system with power steering fluid.

14. Check for leaks.

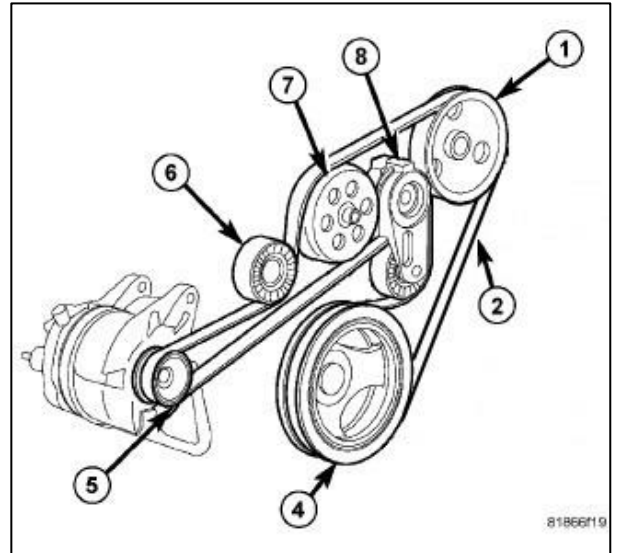

Pump Specifications:

- 9.6 L/min to 11.6 L/min from 1500 RPM to 6000 RPM.
- Power steering fluid recommended being MS-9602 type fluid.
- Drive Ratio – Pump:Engine = 1.35:1.0
- The maximum pump speed is 8500 RPM.
- The maximum pump internal pressure can exceed 2000 PSI.

Power Steering Layout

Follow layout for pressure line and supply line. If using a power steering cooler, position cooler between power steering rack (steering gear) and reservoir. Recommended hose size is 5/8 inch. Power steering systems and components can be subject to over 2000 PSI at peak. Only use power steering hoses and fittings rated for 2500 PSI.

