



Car FEAD Power Steering Add-On Kit

77072448

5.7L & 6.4L Crate HEMI

www.mopar.com



Item	Description	Part Number	Quantity
	Car PS Add-On Kit	77072448	
1	Power Steering Pump	68068641AB	1
2	Bolt, Hex Flange Head, M8X1.25X80	06104206AA	3
3	Belt for Power Steering - 1956mm	05184442AC	1

PLEASE READ ALL INSTRUCTION PRIOR TO INSTALLATION.

CALL MOPAR FOR ASSISTANCE OR FOR FRENCH/SPANISH INSTRUCTIONS 1-888-528-HEMI (4364)

Remove idler pulley bolt (5) and idler pulley (4). Remove three idler bracket bolts (3) and idler bracket (2).

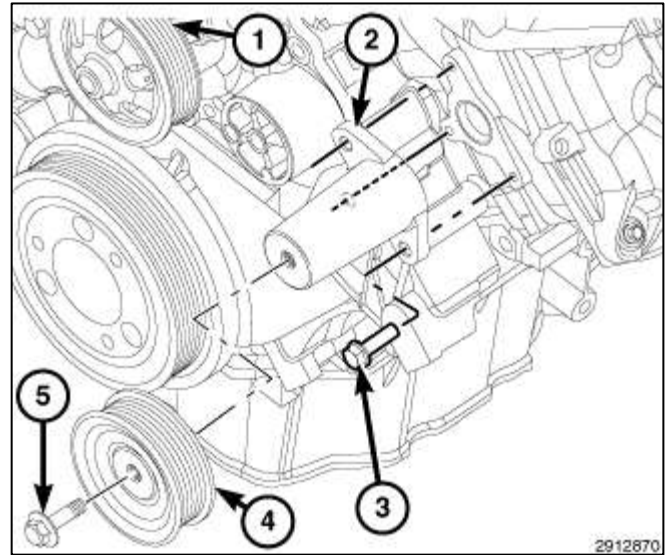

Position the power steering pump (1) and using the holes in the pulley for access, install 3 pump mounting bolts (5) and tighten to 23 N·m (17 ft. lbs.).

Install the pressure line (4) on the pump (1) and tighten the power steering nut to 28 N·m (21 ft. lbs.). Fitting size for pressure line is M16x1.5.

Install the supply hose (3) on the pump (1).

Fill and bleed the system with power steering fluid.

Check for leaks.

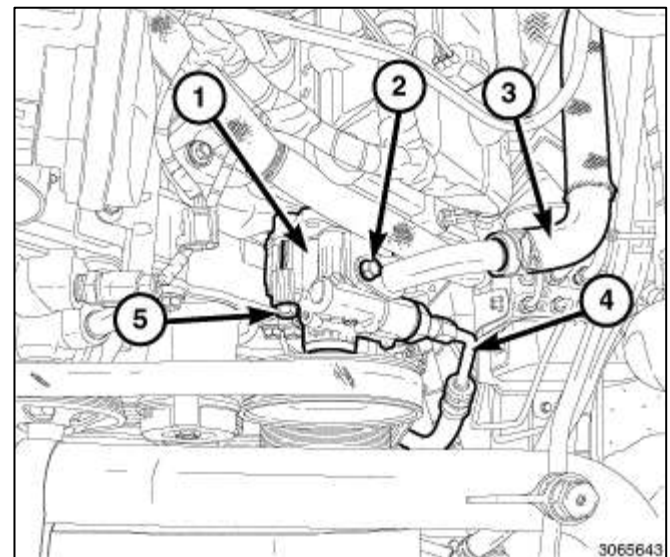

Pump Specifications:

- 9.4 L/min to 11.4 L/min from 1500 RPM to 6000 RPM.
- Power steering fluid recommended being MS-9602 type fluid.
- The maximum pump speed is 8500 RPM.
- The maximum pump internal pressure can exceed 2000 PSI.

Power Steering Layout

Follow layout for pressure line and supply line. If using a power steering cooler, position cooler between power steering rack (steering gear) and reservoir. Recommended hose size is 5/8 inch. Power steering systems and components can be subject to over 2000 PSI at peak. Only use power steering hoses and fittings rated for 2500 PSI.

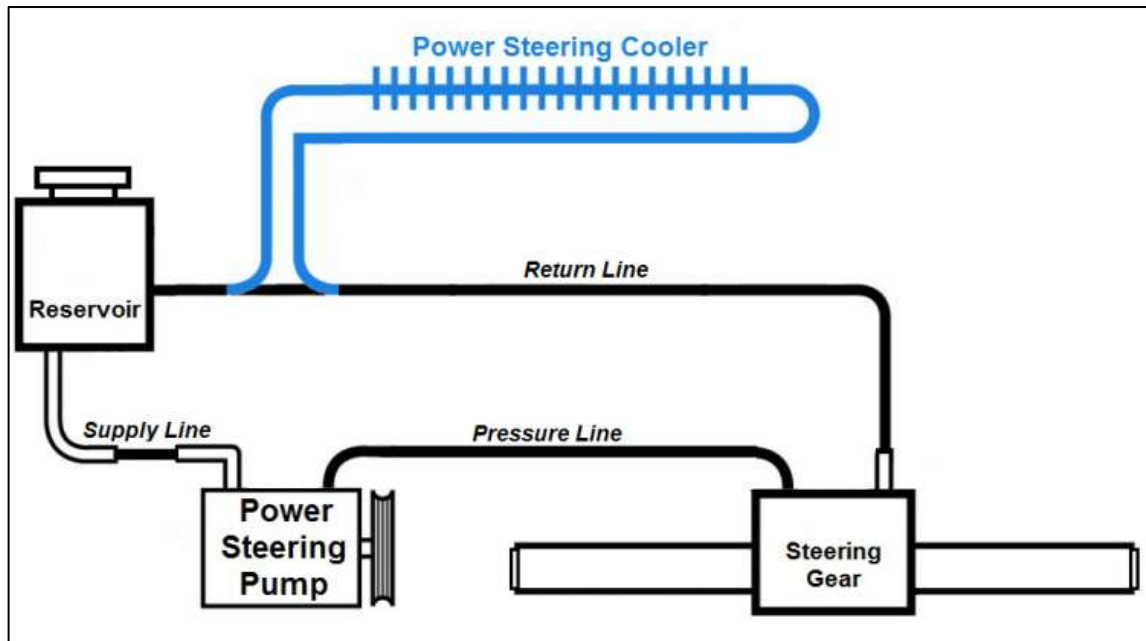

NOTE: When installing accessory drive belt onto pulleys, make sure that belt is properly routed and all V-grooves make proper contact with pulleys.

Position the drive belt (2) over all pulleys except for the water pump pulley (7).

Rotate the tensioner (8) **clockwise** and slip the belt (2) over the water pump pulley (7).

Gently release tensioner (8).

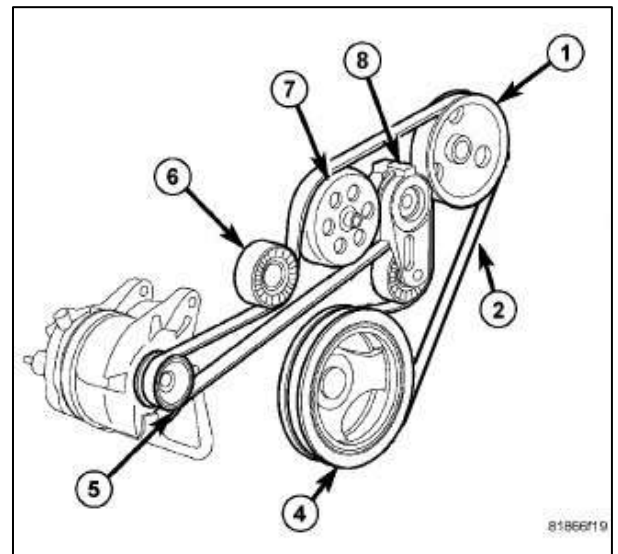

With the addition of the Car AC Add-On Kit (77072446), a new 2100 mm belt will be required; part number 04627031AA.

