

Rear Tow Hook Package Installation (Instruction ID: 85150853)

Installation Instructions Part Number

85150853

Note: This kit comes equipped with one tow hook only. It will be necessary to order an additional tow hook kit in order to install on opposite side.

Kit Contents

Qty	Description
1	Tow hook base
4	Tow hook base bolt
8	Washer
1	D-ring
1	Cross-car-bolt
1	Installation Instructions

Tools required

Power drill

31.75 mm (1-1/4 in) Hole Saw

T-90 6-lobed bit (Torx® or equivalent)

18 mm socket

Torque Wrench

Loctite PN 89021297

Removal Procedure

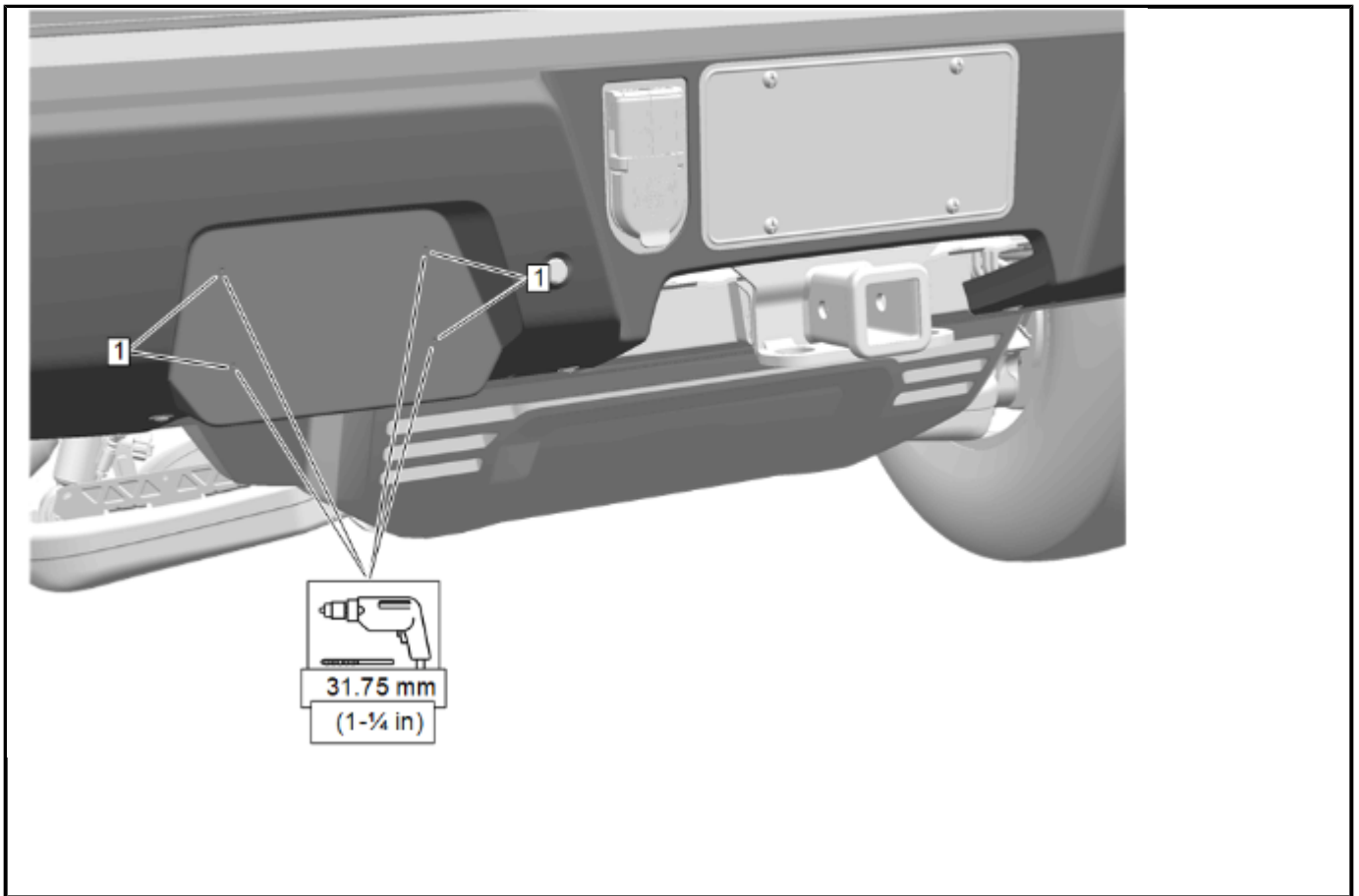

5810906

Caution: Always check size and position of all holes before drilling. Failing to do so may cause damage to the vehicle, misalignment of components or the inability to install the accessory.

Caution: Be careful not to damage components behind fascia while drilling.

1. Locate the dimples (1) in the rear fascia, using the dimple as a guide drill a hole into each of the four dimples of rear fascia using a 31.75 mm (1-1/4 in) hole saw.

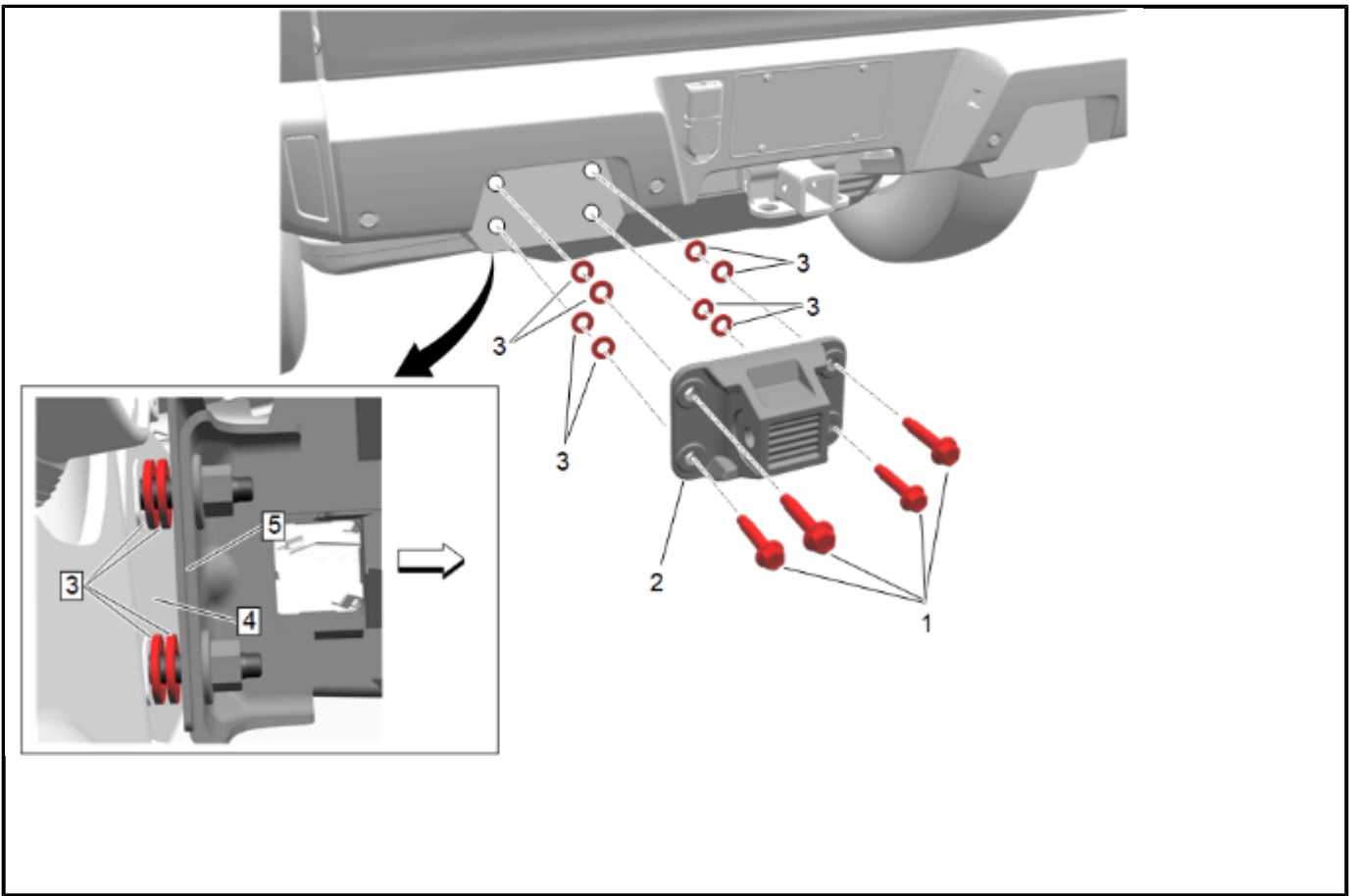

5810907

2. Position the tow hook base (2) to the previously drilled holes in rear fascia.

Caution: Use the correct fastener in the correct location. Replacement fasteners must be the correct part number for that application. Fasteners requiring replacement or fasteners requiring the use of thread locking compound or sealant are identified in the service procedure. Do not use paints, lubricants, or corrosion inhibitors on fasteners or fastener joint surfaces unless specified. These coatings affect fastener torque and joint clamping force and may damage the fastener. Use the correct tightening sequence and specifications when installing fasteners in order to avoid damage to parts and systems.

Note: Wrap the D-Ring/hook with protective tape to prevent damage during installation. Remove tape after installation.

3. Loosely install the tow hook base bolts (2) to the tow hook base (2) making sure to add two washers (3) to each bolt behind rear fascia (4) through drilled holes and between the trailer hitch (5). Do not tighten bolts at this time.

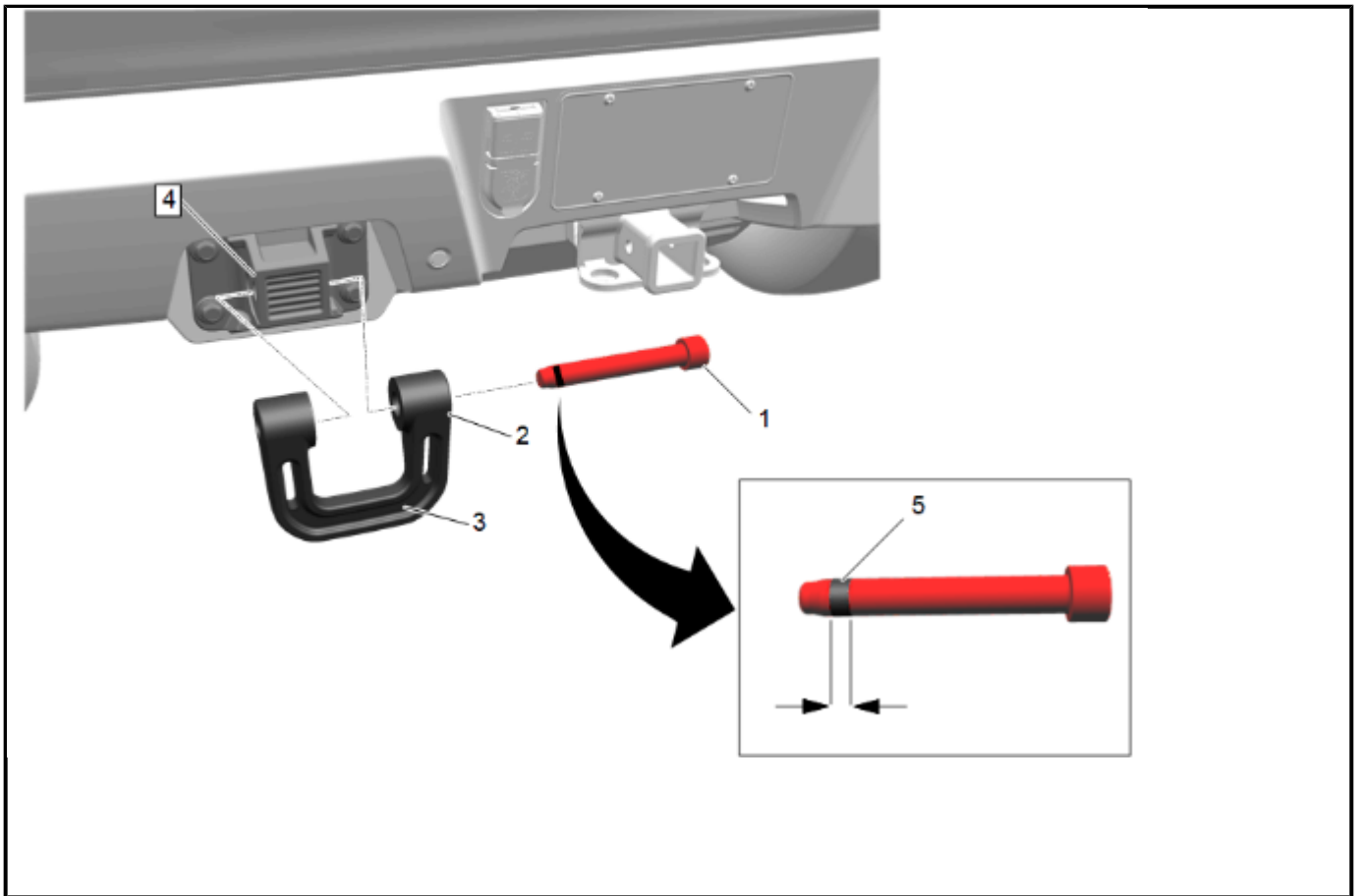

5810908

Note: Make sure to leave tow hook base bolts loose enough in order to install the D-ring and cross car bolt.

4. Install the D-ring (2) to the tow hook base (4) making sure the groove (3) in D-ring is facing toward the outside of vehicle.

Note: Do not install thread locker on the first two threads on cross car bolt.

5. Apply thread locker (5) to threads on cross car bolt (1) and install the cross car bolt (1) to D-ring (2).

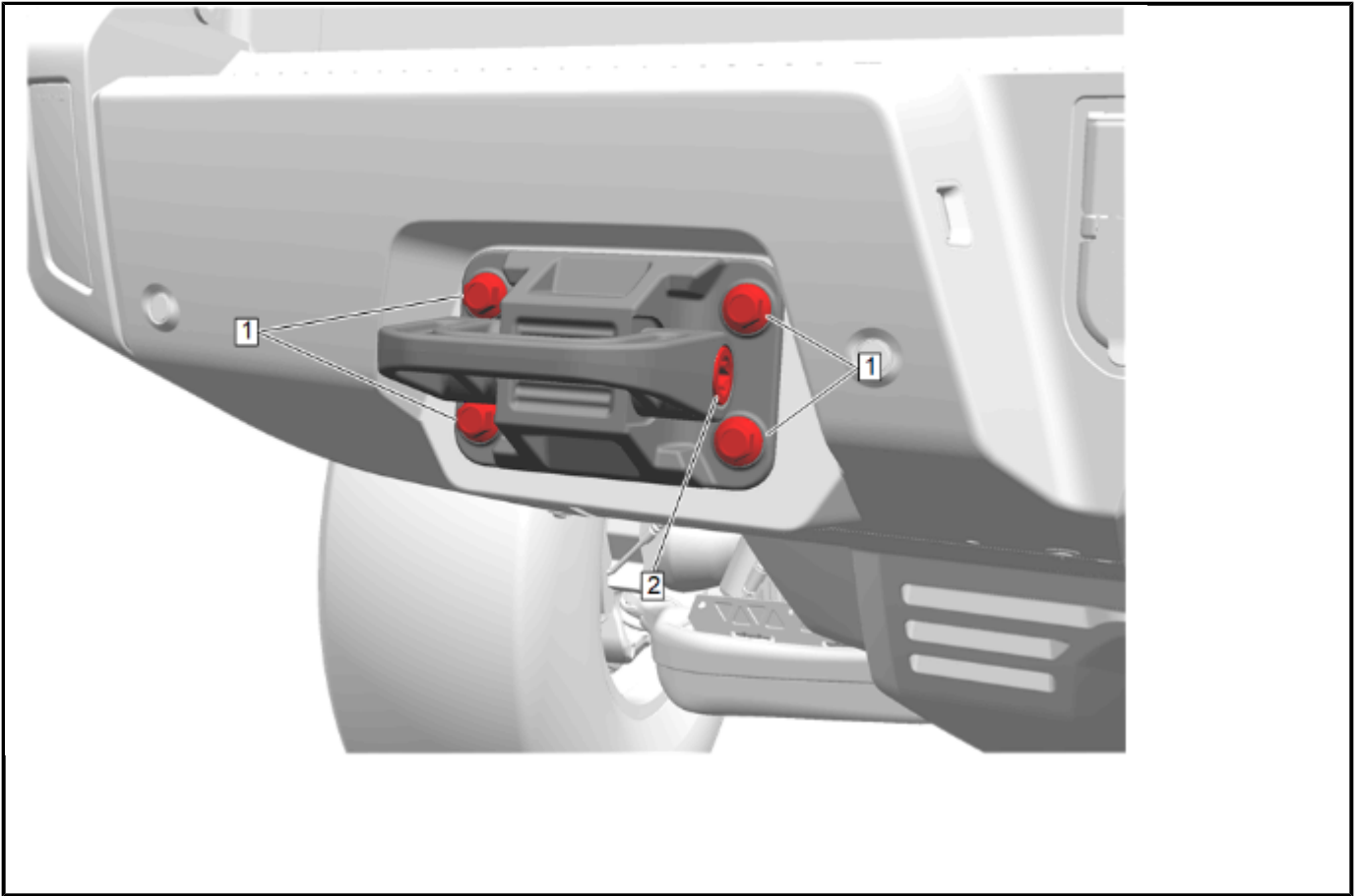

5810909

Note: If using kit P/N 84930570 proceed to step 6.1. for cross car bolt torque. If using kit P/N 86811294 proceed to step 6.2. for cross car bolt torque.

Note: Position the D-ring as needed to avoid scratching during the tightening sequence

6. Cross Car Bolt:

6.1. **For Kit P/N 84930570:** Using a T90 Torx bit, tighten the cross car bolt (2) initially to 80 N.m (59 lb ft), then back off the cross car bolt and tighten to 50 N.m (37 lb ft).

6.2. **For Kit P/N 86811294:** Using a T90 Torx bit, tighten the cross car bolt (2) to 35 N.m (26 lb ft).

Note: Be careful not to squeeze washer. Back down bolt if washer is squeezed.

7. Using an 18 mm socket, tighten the tow hook base bolts (1) in a clockwise pattern to:

7.1. First Pass: **25 N•m (18 lb ft)**

7.2. Second Pass: **50 N•m (37 lb ft)**

7.3. Third Pass: **75 N•m (55 lb ft)**

7.4. Fourth Pass: **100 N•m (74 lb ft)**

8. Repeat steps for opposite side for additional tow hook kit.