



DELTA FORCE

COLD AIR INTAKES

BY FLOWMASTER

Installation Instructions for:

SYSTEM # 615112

2014-2018 DODGE RAM 2500 & 3500

with 6.4L Engine

NOT LEGAL FOR SALE OR USE ON ANY POLLUTION-CONTROLLED MOTOR VEHICLE IN CALIFORNIA OR IN STATES THAT HAVE ADOPTED CALIFORNIA EMISSION PROCEDURES.



Watch our installation video on YouTube

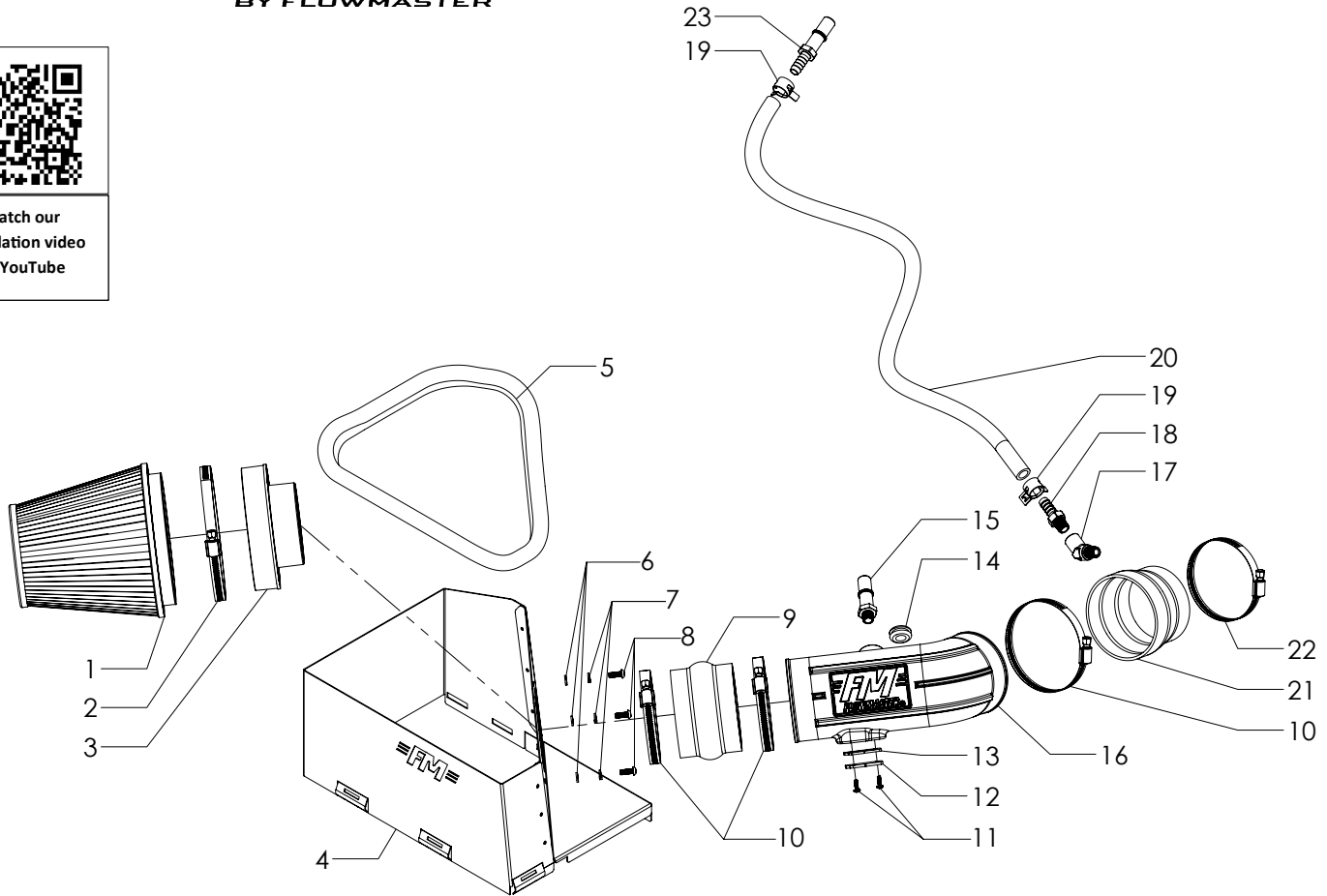

REV. 11/14/17

ITEM NO.	PART NUMBER	DESCRIPTION	QTY.
1	AF1002	AIR FILTER, 7-1/2" x 6" DIA	1
2	AF1002	SCREW CLAMP, #104 (4-1/8" - 7")	1
3	AF6002	ADAPTER, AIR FILTER 4" x 6"	1
4	AF3034	HEAT SHIELD, 14-17, RAM 2500 & 3500, 6.4L	1
5	49000061	GASKET, HEAT SHIELD	48"
6	HW319	FLAT WASHER, M6	3
7	HW318	LOCK WASHER, M6	3
8	HW244	SCREW, M6 x 1.0 x 16MM	3
9	AF4005	COUPLER, FLEX 4" I.D. x 3" L	1
10	MC400H	SCREW CLAMP, #64 (3-9/16" - 4-1/2")	3
11	HW248	SCREW, M4 x 0.7 x 12MM	2
12	AF5064	BLOCK-OFF PLATE, MAF SENSOR	1

ITEM NO.	PART NUMBER	DESCRIPTION	QTY.
13	GA139	GASKET, MAF SENSOR	1
14	AF4008	GROMMET, 1-1/16" OD x 1/2" ID x 7/16" THK	1
15	AF4016	FITTING, STRAIGHT 5/8" QUICK CONN TO 1/4" NPT MALE	1
16	AF2034	INTAKE TUBE, 14-17, RAM 2500 & 3500, 6.4L	1
17	AF4037	ELBOW, 45°, 1/4" NPT MALE TO 1/4" NPT FEMALE	1
18	AF4011	FITTING, STRAIGHT 1/2" BARB TO 1/4" NPT MALE	1
19	MC003P	PINCH CLAMP, 1/2" HOSE	2
20	49000064	HOSE, 1/2" I.D.	42"
21	AF4062	COUPLER, REDUCING 4" - 3-1/2" I.D. x 3" L	1
22	MC350H	SCREW CLAMP, #56 (3-1/16" - 4")	1
23	AF4043	FITTING, STRAIGHT 5/8" QUICK CONN TO 1/2" BARB	1

REVIEW THE INSTRUCTIONS AND VERIFY THE KIT CONTENTS:

1. Please take a moment to read and understand these instructions before installing your Flowmaster cold air intake kit.



2. Use the exploded drawing and parts list (front page) to verify your kit's contents.

In the unlikely event that any parts are missing, please contact Flowmaster Technical Support for replacements.

REMOVE THE FACTORY AIR INTAKE SYSTEM:

NOTES

- We highly recommend that you retain all factory air intake system parts.
 - Please refer to vehicle manufacturer's recommendations regarding removal of factory components.
 - Disconnecting the negative battery cable erases pre-programmed electronic memories. Write down all memory settings before disconnecting the negative battery cable. Some radios will require an anti-theft code to be entered after the battery is reconnected. The anti-theft code is typically supplied with your owner's manual. In the event your vehicle's anti-theft code cannot be recovered, contact an authorized dealership to obtain your vehicle's anti-theft code.
3. Turn off the vehicle's ignition and disconnect the negative battery cable.



4. Remove the engine appearance cover by lifting the front end, then pulling forward.

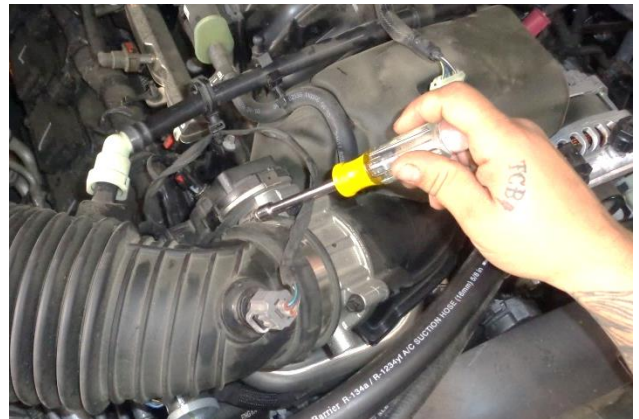

5. Loosen screw clamp that secures the intake duct to the throttle body.

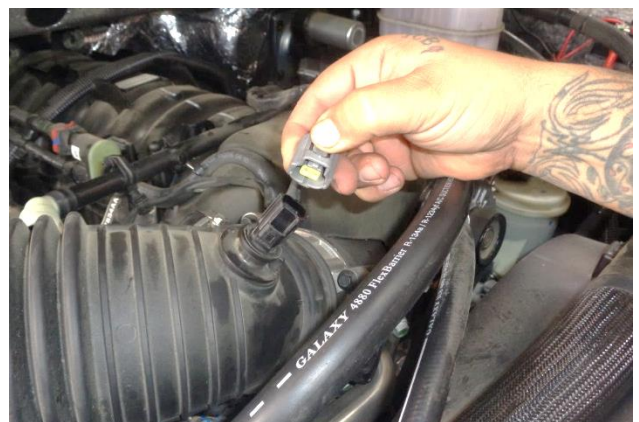

6. Disconnect the air temperature sensor plug by depressing the locking tab and pulling it straight off the sensor.

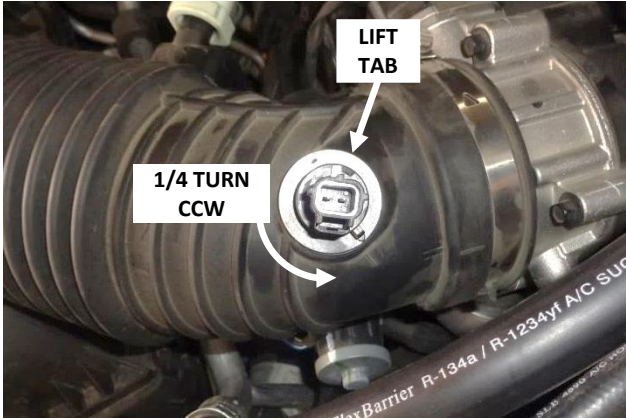

7. Remove the air temp sensor by lifting the locking tab and turning it a quarter-turn counter-clockwise while pulling straight out. Then remove the o-ring from the sensor. **CAUTION: The sensor is delicate!** Handle it with care, and store it in a safe location until reinstallation.

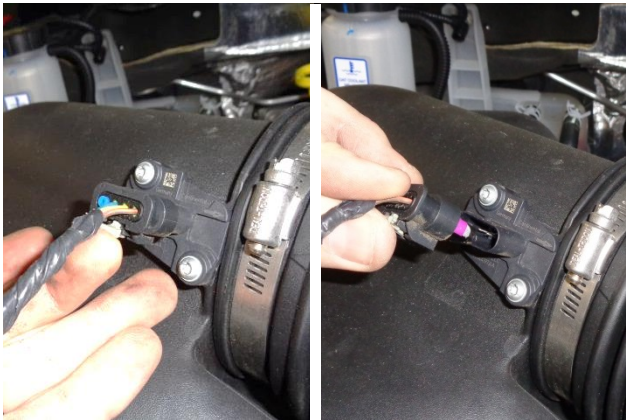

8. **FOR VEHICLES WITH MASS AIRFLOW (MAF) SENSORS:** Disconnect the MAF sensor plug by pulling the locking tab away from the sensor, squeezing the flat sides of the plug, and pulling it straight off the sensor.



9. Remove the PCV line connector from the intake duct.

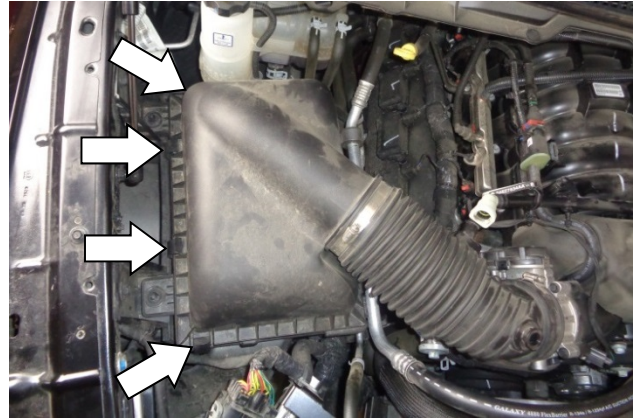

10. Release the four spring latches along the left side of the airbox cover.



11. Remove the airbox cover and stock air filter from the vehicle.

12. **FOR VEHICLES WITH MAF SENSORS:** Remove the MAF sensor from the airbox, then remove the factory gasket from the sensor. **CAUTION: The sensor is delicate!** Handle it with care, and store it in a safe location until reinstallation.

ASSEMBLE AND INSTALL YOUR FLOWMASTER COLD AIR INTAKE SYSTEM:

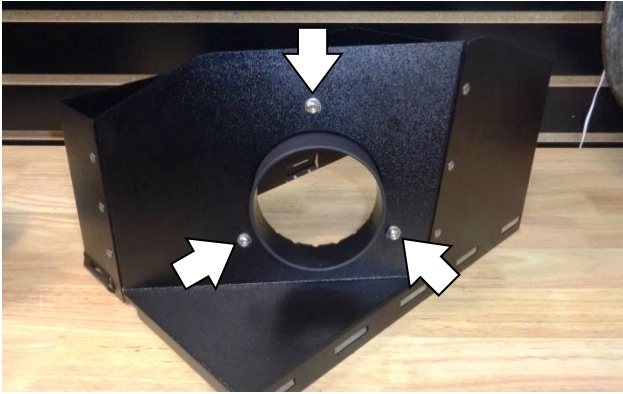

13. Attach the air filter adapter (3) to the heat shield (4) using the M6 screws (8), lock washers (7) and flat washers (6).



14. Attach the gasket (5) to the heat shield. Firmly press the gasket onto the edge, gradually working around the heat shield. When you return to the starting point, trim the gasket to fit using metal-cutting shears.



15. Slip two of the large screw clamps (10) onto the flex coupler (9). Install the coupler on the air filter adapter, pushing it flush against the heat shield. Tighten only the filter adapter clamp at this time. (Leave the other clamp loose.)



16. Place the clamp (2) on the air filter (1), install the filter on the filter adapter and tighten the clamp.

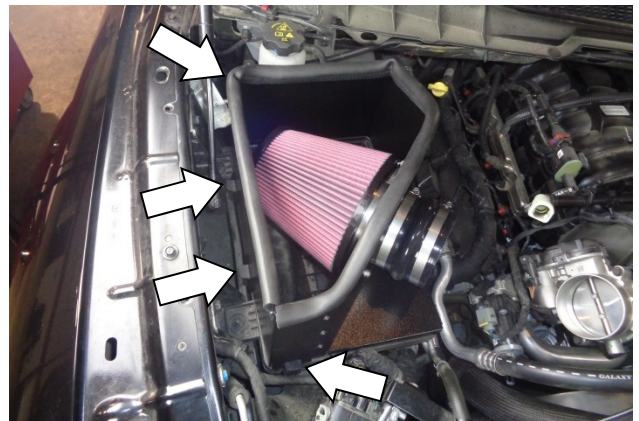

17. Fit the slots on the right side of the heat shield over the tabs on the stock airbox, then secure the heat shield to the airbox with the four latches.



18. Insert the rubber grommet (14) into the intake tube (16). NOTE: Moistening the grommet with soapy water will ease insertion.



19. Carefully push the air temp sensor into the grommet, orienting the tab toward the throttle body opening. NOTE: Moistening the grommet I.D. with soapy water will ease insertion.



20. Depending on your vehicle's configuration, install either the block-off plate (12) or the MAF sensor on the intake tube, using the gasket (13) and M4 screws (11).



21. Apply 2 wraps of nylon thread tape to the 5/8" quick-connect fitting (15), and install it in the intake tube.



22. Install the small screw clamp (22) and large screw clamp (10) on the appropriate ends of the reducing coupler (21). Install the large end of the coupler on the throttle body end of the tube. Snug (but do not yet tighten) just the clamp on the tube.



23. Install the intake tube in the vehicle. Do not tighten any screw clamps at this time.



24. Push the reducing coupler back against the throttle body, and tighten only the throttle body clamp.

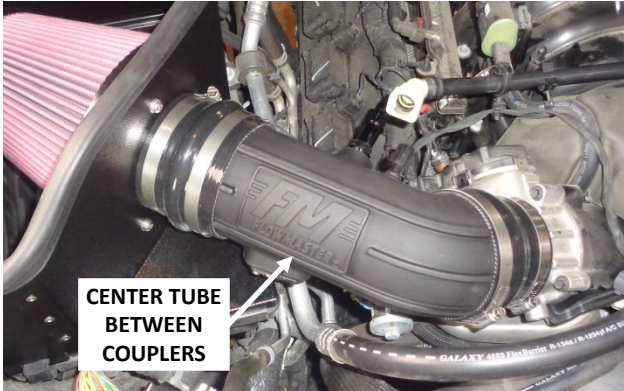

25. Center the intake tube between the couplers, and tighten the two clamps on the intake tube.



26. Reconnect the air temp sensor plug to the sensor and check the plug for security.
FOR VEHICLES WITH MAF SENSORS: Reconnect the plug to the sensor, push the locking tab toward the sensor, and check the plug for security.



27. **STOCK PCV LINE ROUTING (FITS MOST VEHICLES):** Push the PCV connector onto the quick connect fitting until it clicks, **but do not force the connection.** If the line reaches the fitting, verify the connection is secure, then go to Step 34. **If the line doesn't reach the fitting, perform the alternate PCV line routing (Steps 28-33).**

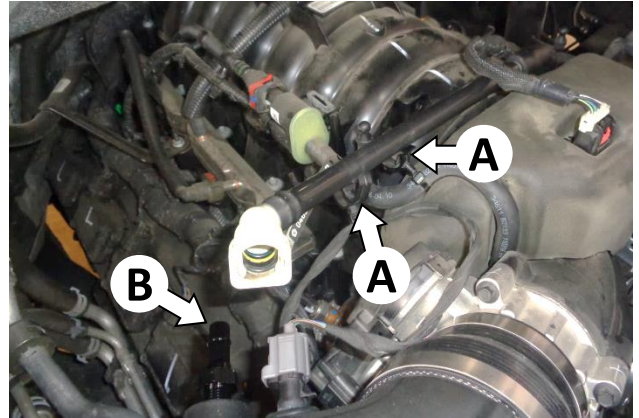

28. **ALTERNATE PCV LINE ROUTING:** Release the PCV hard line from the two clamps (A). Then remove the quick connect fitting (B) from the intake tube.

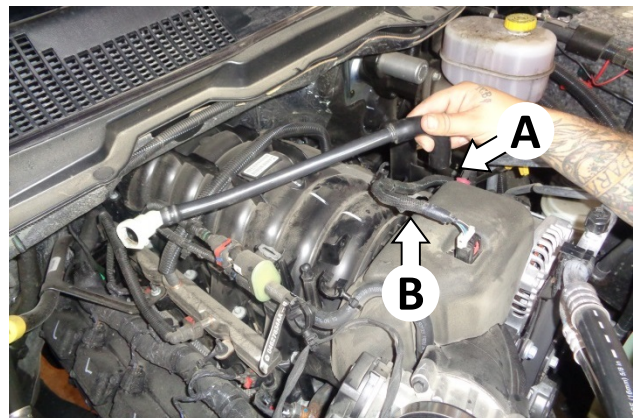

29. Carefully pull the PCV hard line off the engine, and remove the line from under the electrical lead.



30. Use a pinch clamp (19) to secure the 5/8" quick connect \times 1/2" barbed fitting (23) in one end of the 1/2" I.D. hose (20). Then push the fitting into the connector on the PCV hard line.

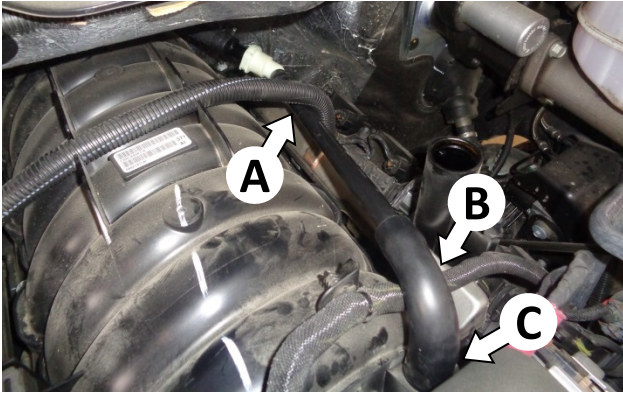

31. Route the hard line under the fuel crossover line (A) and over the electrical lead (B), and reconnect it at the engine end (C).

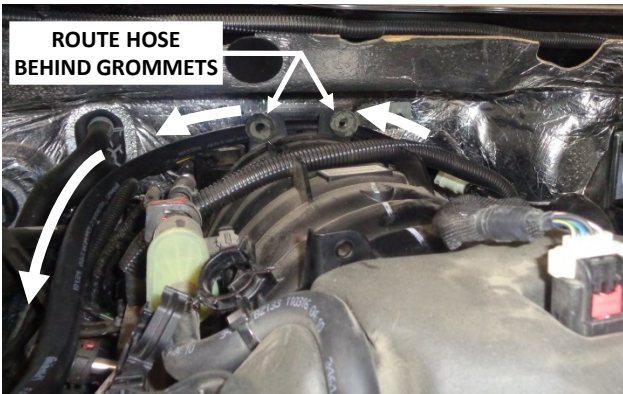

32. Route the 1/2" hose behind the two engine cover mount grommets, then forward toward the intake duct.



33. Apply 2 wraps of nylon thread tape to the 1/2" straight barb fitting (18) and install it in the 45° elbow (17). Apply 2 wraps of thread tape to the elbow and install it in the intake tube, aligning it as shown. Cut the 1/2" hose so that it lays as shown, then use the pinch clamp (19) to secure it to the fitting.



34. Reinstall the engine appearance cover by pushing the two rear pins into their grommets, then pressing the front down onto the two friction pins.



Congratulations, the installation of your FLOWMASTER cold air intake kit is now complete!