



**36-1 Tooth Crank Trigger Systems for Small Block Chevy
P/N 556-116
Installation and Adjustment Instructions**

1.0 INTRODUCTION:

Congratulations on your purchase of a Holley 36-1 Tooth Crank Trigger System! Holley Performance Products cannot and will not be responsible for any alleged or actual engine damage, or any loss or damage resulting from misapplication of the product described herein. However, it is our intent to provide the best possible products for our customers-products that perform properly and exceed your expectations. Should you need information or parts assistance, please contact our Technical Service Department at 1-270-781-9741, Monday through Friday, 8 a.m. to 5:00 p.m. Central Time; please have the part number of the product you purchased when you call.

These systems are designed to provide an engine speed & position signal specifically to Holley EFI systems. The kit's 1/4", 35 tooth wheel will provide a very accurate crankshaft speed & position signal to the ECU in the most-demanding of racing applications. These systems come with the bracketry, mounting hardware, & ferrous-target, hall-effect sensor necessary for installation.

WARNING! These instructions must be read and fully understood before beginning installation. Failure to follow these instructions may result in poor performance, vehicle damage, personal injury or death. If these instructions are not fully understood, installation should not be attempted. Extreme caution should be exercised when working near or around the 36-1 crank wheel during regular engine operation as serious injury or dismemberment could occur. Keep hair, clothing, & hanging objects away from the crank wheel at all times.

2.0 APPLICATIONS

These kits were designed specifically for use on early model Small Block Chevy applications equipped with a standard, aftermarket ATI *Super Damper* or *Fluidampr* "style" harmonic balancer up to 7-1/4" in diameter. The 8" trigger wheel included with these kits were designed to center off of the hub of the balancer & therefore, does not require a centering ring for wheel centering. Consequently, these kits will not work on balancers which do not have a center-hub extrusion (i.e.: Innovators West, etc.). These wheels will only work with balancers having a 3-hole, wheel mounting bolt-pattern.

NOTE: Universal 8" & 7.25" diameter, 36-1 tooth, crank wheels are available for custom balancers not supported by this kit. These are available as Holley PN's: 556-125 & 556-126 respectively. These wheels require finished-machining for bolt-hole pattern & hub extrusion recess (if applicable). When selecting a wheel for a given balancer, ensure that the wheel diameter is at least 3/4" larger than the diameter of the balancer it is intended to operate on.

NOTE: Mounting the 36-1 crank trigger wheel will space the lower pulley out approximately 3/16". This requires that all other pulleys be moved out 3/16" as well to maintain proper alignment.

3.0 PARTS IDENTIFICATION

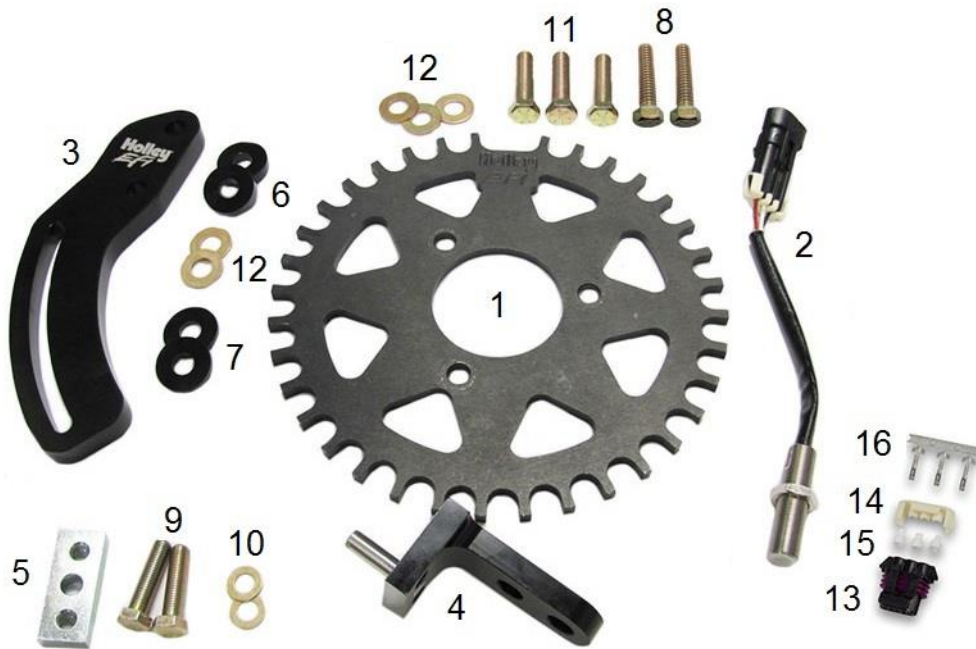

Item #	Qty.	Components
1	1	8" 36-1 Tooth x 1/4" wheel
2	1	M12x1mm Sensor w/Jam Nut
3	1	Engine Block Bracket
4	1	Sensor Mounting Bracket
5	1	Threaded Back-plate
6	2	1/4" Thick Aluminum Spacers
7	2	1/8" Thick Aluminum Spacers
8	2	3/8"-16 x 1.5" Screws
9	2	5/16"-24 x 1.25" Screws
10	2	5/16 Mil Spec Washers
11	3	3/8"-16 x 1.25" Screws
12	5	3/8" Mil Spec Washers
13	1	Connector
14	1	TPA Lock
15	3	Seals
16	3	Pins

4.0 MATERIALS REQUIRED FOR INSTALLATION

- 17mm, 1/2", 9/16" Wrenches
- Small Crescent wrench
- Medium-Strength thread adhesive

5.0 ATTACHING THE SENSOR MOUNTING BRACKET TO THE ENGINE BLOCK BRACKET

1. Use the threaded back-plate (5), 5/16"-24x1.25" screws (9), & 5/16" washers (10) to secure the sensor mounting bracket (4) to the engine block bracket as shown in **Figure 1**.

NOTE: The bolt holes on the threaded back-plate are drilled slightly off-center to accommodate the slot on the engine-block bracket. Consequently, the threaded back-plate is directionally oriented & will only go on one way.

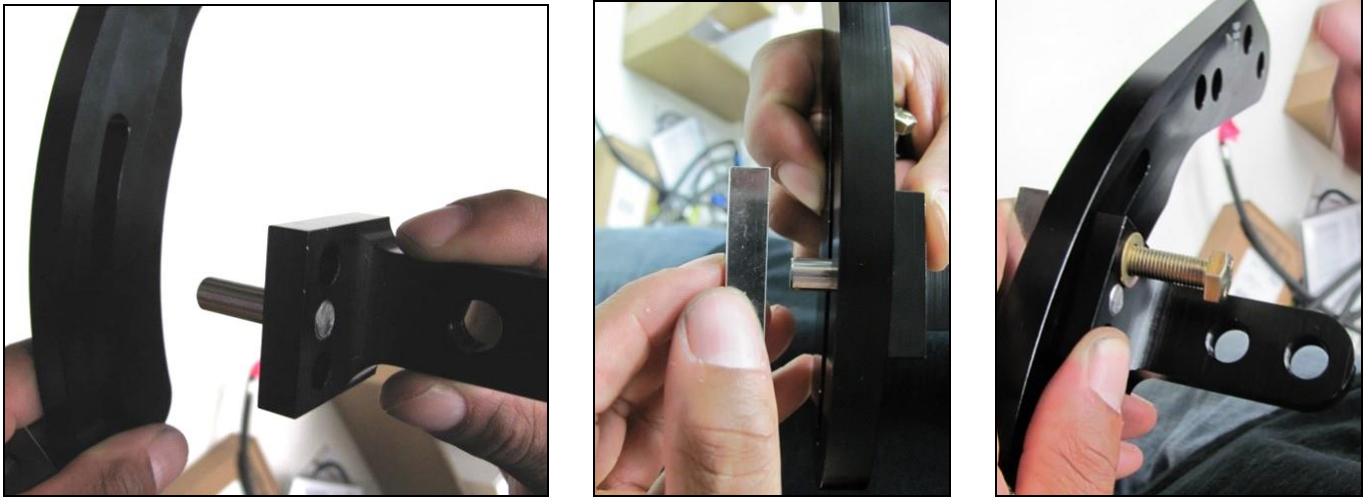

Figure 1: Securing the sensor bracket to the engine block bracket.

- Slide the sensor bracket to the approximate center of the block bracket's slot & lock it in place by hand-tightening the 5/16" screws as shown in **Figure 2** below. Do not tighten these screws at this time as final sensor-to-wheel angular adjustment will need to be made prior to doing so. (See section 7 for details.)



Figure 2: Centering the sensor bracket.



Figure 3: Installing the sensor.

- Back the sensor's jam nut approximately half way up the sensor (2) and thread the sensor into the sensor mounting bracket (4) until it protrudes about a 1/8" as shown in **Figure 3** above.

5.0 INSTALLATION OF THE ENGINE-BLOCK BRACKET ASSEMBLY

NOTE: This kit includes two 1/4" & two 1/8" thick aluminum spacers (item numbers 6 & 7) to be used when attaching the engine-block bracket. All four are intended to be used when no front motor plate is used & only the two 1/8" spacers are meant to be used when a front motor plate is used. This assumes a motor plate thickness of 1/4". Due to variations in lower cam pulley thicknesses, motor plate thicknesses, & balancer stack-ups, it may be necessary to eliminate, replace, or modify the provided spacers in some applications. Standard 3/8" washers of various thicknesses can be used for bracket spacing if necessary.

- Use the 3/8"-16 x 1.5" screws (8), two 3/8" washers (12), & appropriate spacers (6 &/or 7) - as necessary, to mount the motor bracket to the driver or passenger side of the engine as shown in **Figure 4** below.

2. Use a 9/16" wrench to tighten the 3/8" screws. Keep in mind, the engine-block bracket may need to be removed later to add or remove spacers or washers to establish proper sensor-to-wheel alignment. For this reason it is best to wait until final sensor-to-wheel standoff alignment has been verified prior to using thread adhesive.



Figure 4: Mounting the engine-block bracket to the engine.

6.0 INSTALLATION OF THE 36-1 CRANK TRIGGER WHEEL

1. Manually rotate the engine to TDC (Top Dead Center) of the #1 cylinder as shown in **Figure 5** below.
2. Check the hub surface to which the crank trigger wheel (1) will be mounted to ensure that it is smooth & free of any excess dirt, debris, or oil. Clean the face of the balancer as required.
3. With the *Holley EFI* logo facing outward, center the wheel on the hub of the balancer using the recess on the rear of the wheel.
4. Rotate the crank wheel until the 7th-tooth index mark lines up with the approximate centerline of the sensor. The wheel was designed such that the bolt-holes on the wheel should line up to those of the balancer under these conditions. This should provide a mechanical reference angle of 60° BTDC #1, assuming a standard key-way location on the crankshaft.
5. Adjust the wheel as necessary to align the bolt holes & secure the crank wheel to the balancer using the supplied 3/8"-18 x 1.25" screws (11) & 3/8" washers (12) as shown in **Figure 7**. Apply a liberal amount of medium-strength thread adhesive (minimum) to the threads of the screws prior to tightening.
6. Once the crank wheel has been securely fastened to the balancer, make any final sensor-to-wheel angular adjustments by sliding the sensor bracket in the engine-block bracket until the sensor's centerline is located directly on the 7th-tooth index mark. Use a 1/2" wrench to tighten the sensor bracket in place. Thread adhesive is required on the threads of the 5/16"-24 screws prior to final tightening.



Figure 5: Rotating the engine to TDC #1.

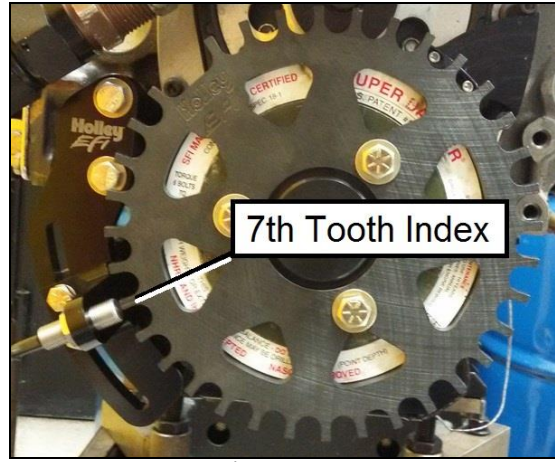

Figure 6: Aligning 7th tooth index mark for mounting.



Figure 7: Fastening the crank wheel to the balancer.

7.0 ADJUSTING SENSOR ALIGNMENT & SETTING SENSOR GAP



Figure 8: Adjusting the sensor gap.



Figure 9: Locking the sensor gap.

1. Before setting final sensor gap, ensure final sensor-to-wheel stand-off alignment by adding, removing, or modifying the provided 1/4" and/or 1/8" spacers. 3/8" washers may also be used behind the engine block bracket as needed. A medium-strength thread-adhesive should be used prior to final installation of the engine block bracket & sensor assembly.
2. Use a feeler gauge to set the gap to .040"-.080" by backing the jam nut off and screwing the sensor in or out of the sensor bracket, as shown in **Figure 8**, above. The closer the better.

3. With a small crescent wrench on the sensor & a 17mm on the jam nut, lock the sensor in place by holding the sensor stationary & torquing down on the nut, as shown in **Figure 9** above. Do not tighten the jam nut beyond 23 ft.-lbs or damage to the sensor's threads may result.

NOTE: Ensure there will be no physical contact between the sensor and crank wheel when the engine is in operation. This should be done by manually rotating the engine a full revolution & visually verifying no contact can be made.

8.0 SENSOR WIRING & SETUP

Loose pins (16) and seals (15) are included and must be crimped onto an existing harness like Holley P/N 558-431 or 558-306. Use the proper tools to crimp Metripak 150 style pins (Delphi P/N: 12155975 - Available thru Waytek, Inc. Item No.: 509). It is advised to use shielded wiring (with drain wire grounded at the ECU end) to connect to this sensor. The pins are inserted into the back of the connector. Install the TPA lock (14) after the wires are inserted.

The following is the proper wiring for this sensor:

- A – Red – 8V to 20V clean switched power. Pin B20 (“EST 12V Output”) on Holley EFI systems would be a good choice. Pin E at the “Ignition” connector of Holley P/N 558-431 or 558-306.
- B – White – Sensor Output to ECU crank signal (Pin A30 on Holley EFI). Pin A at the “Ignition” connector of Holley P/N 558-431 or 558-306.
- C – Black – Sensor ground. Connect to a “clean” ECU ground, such as pin A14 (“IPU Ground”) on Holley EFI systems. Pin C at the “Ignition” connector of Holley P/N 558-431 or 558-306.

1. If using Holley EFI, set initial ignition software parameters as seen in **Figure 10** below.
2. Be sure to check the ignition timing after the engine is started. This is best performed using the “Static Timing Set” feature located under the ECU Sync  drop-down. Discrepancies in ignition timing can be corrected using the “Timing Offset” field. Ignition timing drift with engine speed can be corrected using the “Inductive Delay” parameter. Adding inductive delay will advance ignition timing with increasing engine speeds & removing it will retard ignition timing with increasing engine speed. These adjustments can be made in increments of 10 usec until the ignition timing is close. A key-off cycle will be required before any of these modifications will be effective.

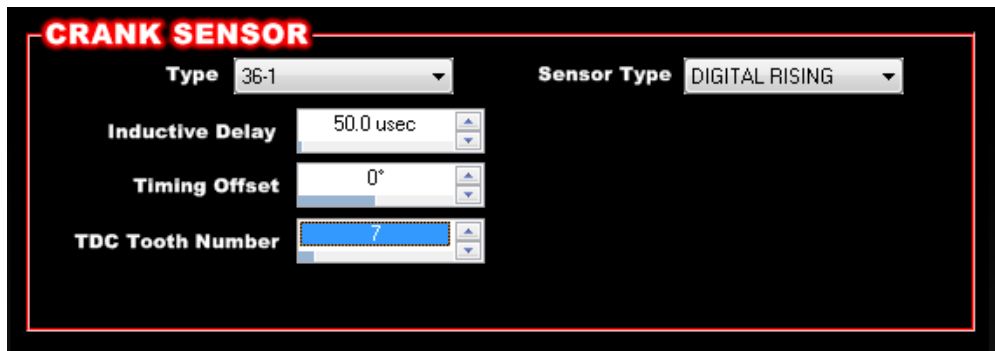

Figure 10: Initial software settings.

HOLLEY TECHNICAL SUPPORT: 1-270-781-9741

© Holley Performance Products, Inc.

199R10892

Date: 10-6-15